

## "KMSA DIGITAL Self Venting"

### Configuration

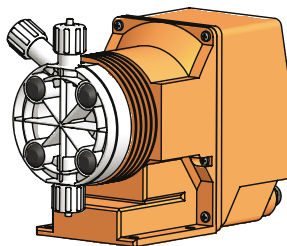

Power supply: 230 VAC (190÷265 VAC)  
 Power supply: 115 VAC (90÷135 VAC)  
 Power supply: 24 VAC (20÷32 VAC)  
 Power supply: 12 VDC (10÷16 VDC)

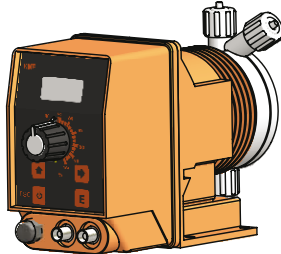

MODELS		
Standard	Self Venting	
DC	AF	*KMS DC* Digital constant pump, stand-by input and alarm output and level control.
MF	AD	*KMS MF* Digital Multifunction pump (Constant, Divide, Multiply, PPM, Batch, Volt, mA, %, MLQ), stand-by and flow sensor input, alarm output and level control.
ML	MA	*KMS CL* Proportional pump for free chlorine (CL) control (from 0 to 10,00 mg/l) with level control, supplied without chlorine probe. It operates with chlorine cells mod. ECL1 and ECL6/7/12, not provided.
EN	AN	*KMS EN* Pump with weekly timer, microprocessor, digital controls, LCD display, level probe and electrovalve control.
PH	AH	*KMS PH* Proportional pump driven by internal built-in pH meter (0÷14pH) and level control, supplied without pH probe.
RH	AR	*KMS RH* Proportional pump driven by internal built-in Redox (ORP) meter (0÷1000mv) and level control, supplied without Redox probe.

CAPACITIES			HOSES	VALVES
2001	1 l/h at 20 bar	0.26 GPH at 290 PSI	4x6	3/8"
1802	2 l/h at 18 bar	0.53 GPH at 261 PSI	4x6	3/8"
1504	4 l/h at 15 bar	1.06 GPH at 217 PSI	4x6	3/8"
1005	5 l/h at 10 bar	1.32 GPH at 102 PSI	4x6	3/8"
0808	8 l/h at 8 bar	2.11 GPH at 116 PSI	4x6	3/8"
0510	10 l/h at 5 bar	2.64 GPH at 58 PSI	4x6	3/8"
0218	18l /h at 2 bar	4.76 GPH at 29 PSI	6X8	3/8"
CAPACITIES SELF VENTING MODELS				
1801	1 l/h at 18 bar	0.26 GPH at 261 PSI	4x6	3/8"
1503	3 l/h at 15bar	0.79 GPH at 217 PSI	4x6	3/8"
103,5	3,5 l/h at 10 bar	0.92 GPH at 145 PSI	4x6	3/8"
085,5	5,5 l/h at 8 bar	1.45 GPH at 116 PSI	4x6	3/8"
057,5	7,5 l/h at 5 bar	1.98 GPH at 72 PSI	4x6	3/8"
0213	13 l/h at 2 bar	3.43 GPH at 29 PSI	6X8	3/8"

POWER SUPPLY	
00	230 VAC Schuko plug
0S	230 VAC Australian plug
01	230 VAC Whitout plug
03	115 VAC US plug
04	24 VAC Whitout plug
05	12 VDC *
07	24 VDC
* Not available on some models.	

Model **K - MF 2001 V 00 00**

LIQUID ENDS								
	Pump head	Orings	Valves		Diaphragm	Hoses		Viscosity Max CPS
			Body	Balls		Delivery	Suction	
V	PVDF	Viton®	PVDF	Ceramic	PTFE	PVDF	PVC	100
D	PVDF	Etylene Propylene	PVDF	Ceramic	PTFE	PVDF	PVC	100
W	PVDF	Nytrile	PVDF	Ceramic	PTFE	PVDF	PVC	100
T	PVDF	Viton®+PTFE	PVDF	Ceramic	PTFE	PVDF	PVC	100
A	Acrylic	Viton®	Polypropylene	Ceramic	PTFE	Polyethylen	PVC	100
Z	INOX	Viton®	INOX	INOX	PTFE	N/A	N/A	100
\$	Acrylic	Viton®	Polypropylene	INOX+ Hastelloy spring	PTFE	Polyethylen	PVC	8000*

*Viton® is a registered trademark of DuPont Dow Elastomers.*

*\* Using high viscosity pup head model "\$" , pump output may results lower in some applications.*

# “KMS DIGITAL” series metering pumps

# Data Sheet

## “KMSA DIGITAL Self Venting”

INFORMATION								
	Stroke speed		Stroke length range reliability	Power consumption at max flow (230VAC)	Power consumption at max flow (115VAC)	Power consumption at max flow (24VAC/VDC)	Power consumption at max flow (12VDC)	Weight
	Min	Max						
	Strokes hour	Strokes minute						
2001	1	180	from 30% to 100%	19 Watt	24 Watt	12 Watt	8.8 Watt	4.1 Kg (9.02 Lbs)
1802	1	180						
1504	1	180						
1005	1	180						
0510	1	180						
0218	1	180						
INFORMATION FOR SELF VENTING MODEL								
1801	1	180	from 30% to 100%	19 Watt	24 Watt	12 Watt	8.8 Watt	4.1 Kg (9.02 Lbs)
1503	1	180						
103,5	1	180						
057,5	1	180						
0213	1	180						

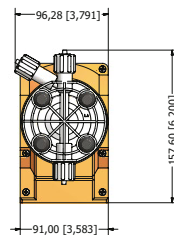
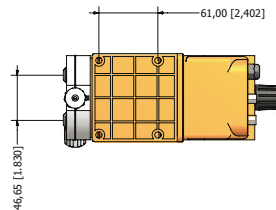
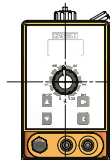
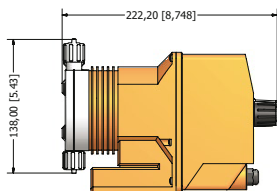

mm [inches]

Protection IP65 (NEMA4x)  
 “KMS DIGITAL” metering pumps are manufactured in molded glass filled and Polypropylene housing aggressive chemicals and tough environment.

INFORMATION								
	Flow				cc per stroke		max pressure	
	Min cc/h	Max l/h	Min GPH	Max GPH	Min	Max		
2001	0.03	1	0.000008	0.26	0.03	0.09	20 bar	290 PSI
1802	0.06	2	0.000016	0.53	0.06	0.19	18 bar	261 PSI
1504	0.11	4	0.000029	1.06	0.11	0.37	15 bar	217 PSI
1005	0.14	5	0.000037	1.32	0.14	0.46	10 bar	145 PSI
0808	0.22	8	0.000058	2.11	0.22	0.74	8 bar	116 PSI
0510	0.28	10	0.000074	2.64	0.28	0.93	5 bar	72 PSI
0218	0.50	18	0.00013	4.76	0.50	1.67	2 bar	29 PSI
INFORMATION SELF VENTING MODELS								
1801	0.03	1	0.000008	0.26	0.03	0.09	18 bar	261 PSI
1503	0.08	3	0.000021	0.79	0.08	0.28	15 bar	217 PSI
103,5	0.10	3.5	0.000026	0.92	0.10	0.32	10 bar	145 PSI
085,5	0.15	5,5	0.000040	1.45	0.15	0.51	8 bar	116 PSI
057,5	0.21	7.5	0.000055	1.98	0.21	0.69	5 bar	72 PSI
0213	0.37	13	0.000098	3.43	0.37	1.20	2 bar	29 PSI